

# MOUNT ROSKILL GRAMMAR SCHOOL NEWSLETTER



SEPTEMBER/  
OCTOBER  
2013

## FROM THE PRINCIPAL'S DESK

Nga mihi nui ki a koutou

Our senior students have recently completed practice examinations. These exams allow students to gauge their progress and to grapple with the complex task of organizing a revision programme, using their time productively. At assembly in the final week of term I talked about what needed to happen before, during and after this study break:

### Know the task

Students have been using the last week of term to identify exactly what needs to be revised over the study break taking note of feed forward from teachers.

### Work hard, play hard

The study break needs careful planning to ensure there is time for refreshment, revision and meeting family responsibilities.



## INSIDE THIS ISSUE

<a href="#">Hockey Turf Fundraising Launch</a>	2
<a href="#">International Homestay</a>	2
<a href="#">Mentoring</a>	3
<a href="#">Senior Prizegiving</a>	3
<a href="#">Dates for Your Diary</a>	3
<a href="#">Diwali Night Fundraiser Event</a>	4
<a href="#">Science and Technology Fair Success</a>	5
<a href="#">Year 13 Production</a>	6
<a href="#">Schools Tournament Week News</a>	7
<a href="#">School Cross Country</a>	7
<a href="#">School Chess News</a>	8
<a href="#">Gateway Scheme News</a>	9
<a href="#">Quiz Night Fundraiser</a>	10
<a href="#">Mangere/ Mangere Bridge - Bus Services</a>	10
<a href="#">Second Hand Uniform</a>	10
<a href="#">Photograph Orders</a>	11
<a href="#">Safe Parking Around School</a>	11
<a href="#">Visual Arts - Pah Homestead Event</a>	12
<a href="#">United Nations International Day of Peace</a>	12
<a href="#">Wider Education</a>	13
<a href="#">Food and Hospitality Department</a>	13
<a href="#">Adult Community Education Term 4</a>	14
<a href="#">Sponsorship for School Teams</a>	16
<a href="#">ASB BBQ Donation</a>	17
<a href="#">School Sponsors</a>	17
<a href="#">MRGS 1stXI Football - Raffle Sponsors</a>	18

### Stay until the job is done

On return to school every senior student will be working towards the best possible external grades and some will be required to complete the necessary learning for internal standards. We are very serious about all students finishing strongly and achieving well in 2013.

During the term cabling has been laid throughout the school and into every classroom as part of the School Network Upgrade Project (SNUP). This \$1.2 million project largely funded by the government will be completed early in term 4. At the same time we have recently connected ultrafast broadband. Combined, the two projects will result in a big change in the capacity of our network to support learning. During next year we will be working towards using tablet devices with the aim of further shifting student learning towards authentic and collaborative contexts.

Our fundraising for the redevelopment of the Hockey Turf is proceeding well. Next term the fundraising the Diwali evening (November 1) and the quiz (November 8) will be great opportunities to meet other members of the school community while supporting the fundraising effort. We hope to see you there!

Best wishes for a refreshing and productive break away from school routines.

Ki nga taumata

Greg Watson, **PRINCIPAL**

Principal: G. Watson, MSc (Hons), MEd Admin (Hons)  
Phone: 621-0050  
Website: [www.mrgs.school.nz](http://www.mrgs.school.nz)

Frost Road  
Mount Roskill  
Auckland 1041



## MRGS FUNDRAISING FOR THE HOCKEY TURF AND SPORTS PAVILION

The fundraising project for the Hockey Turf Redevelopment and the Sports Pavilion was launched as part The MRGS Diamond Jubilee on Saturday 17<sup>th</sup> August. The Hockey Turf Redevelopment is a \$1.5 million dollar project to upgrade the turf into a water based turf.

The Hockey Turf project development subcommittee consists of Auckland Hockey Association, Roskill Eden and Mt Eden Hockey Clubs and MRGS. This group has already been very successful in obtaining \$400,000 from the Auckland Council Central Facility Partnership Committee.

The new fundraising display board complete with its thermometer is now on display outside the school and will be updated as fundraising progresses



### Where to from here? You are all welcome to get involved in fundraising.

We now have \$1.1 million to raise for the turf. MRGS also has plans to build a sports pavilion which will be located between the Hockey turf and the Rugby fields so we have lots of fundraising to do. The MRGS fundraising committee had its first meeting on the 22<sup>nd</sup> August at the school. If you missed that meeting and still want to get involved please contact Ella Kumar on [Ella.Kumar@aucklandcouncil.govt.nz](mailto:Ella.Kumar@aucklandcouncil.govt.nz) or Judith Bingham [jcl.air@xtra.co.nz](mailto:jcl.air@xtra.co.nz) or Marjet Pot on [potgull@ihug.co.nz](mailto:potgull@ihug.co.nz). We aim to make this fundraising fun so contact us and support your children's school.

If you have fabulous ideas for fundraising or know of companies who may wish to sponsor aspects of the turf or sports pavilion then please contact the above people. We would welcome such calls.

If you wish to make a donation to this project please make this direct to the school office or post to Mt Roskill Grammar School, Frost Rd, Mt Roskill, Auckland 1041

All donations over \$5.00 qualify for the IRD's Donation Tax Credit

Marjet Pot, MRGS Fundraising committee  
[ Photo courtesy of the Central Leader ]

## INTERNATIONAL HOMESTAY

We are looking for caring Kiwi homestays to take students in 2014. Families need to provide students with their own room, bed, desk, lamp and heating in winter, along with 3 meals a day.

If you are interested in becoming a homestay parent and live close to the school, please fill in the homestay application forms on our website [www.mrgs.school.nz/international](http://www.mrgs.school.nz/international) or contact Sandra Flessak in the main office.



## MENTORING UPDATE

All Parents of our Year 11 and 12 students are warmly invited to the Mentoring Parent Conference on the **17<sup>th</sup> October 2013**. Your son/daughter's mentor will contact you to make an appointment time for this conference.

This is a very important conference for your son/daughter and we therefore hope you will ensure you can attend to discuss your son/daughter's results from the exams and to ensure we can plan together the next steps for success.

Thank you to all those parents of our Year 11 and 12 students who responded to our survey about Mentoring. The results were very positive and we are pleased to report that most parents found these mentoring conferences very useful. There were also some ideas in the feedback which will help us with our plans for 2014.

Julie Small - Deputy Principal



## SENIOR PRIZEGIVING

The MRGS senior prizegiving is on **Thursday 31<sup>st</sup> October** (week 3 of term 4) starting at **6pm**. Families are more than welcome to attend and all senior students are expected to wear immaculate school uniform. More information will be available next term. We look forward to seeing you as we acknowledge and celebrate our students' achievements.



## DATES FOR YOUR DIARY

TERM FOUR			
October 14	Start of term Four	October 31	Senior Prizegiving
October 17	Parent/Mentor/Mentee meetings—school early closure	November 1	Last Day for Senior Students Diwali Night Fundraiser
October 17	PFA Year 13 Farewells	November 8	MRGS Quiz Night Fundraiser
October 22	Roskill Media Film Awards	November 11	NZQA Examinations Start
October 23	Campus Maori Graduation	November 18 & 19	Junior School Examinations
October 24	Sports Awards Evening Y13 Leavers House Assemblies	November 28	Junior Swimming Carnival
October 25	Y13 Leavers House Assemblies	December 3	NZQA Examinations End
October 25	Y13 Leavers House Assemblies	December 4—6	Wider Education
October 28	Labour Day Holiday	December 10	Junior Prize giving; Junior reports Issued End of Term Four



# PUKETAPAPA (Mt Roskill)

## First Diwali Night Fundraiser



**Date:**

**Friday**

**1<sup>st</sup> November  
2013**

**Venue:**

**Mount Roskill  
Grammar School,  
Butler Hall**

**Address: Frost Road, Mount Roskill**

**Time:**

**7:30-9:00pm**

**Cost:**

**\$10.00 pp or**

**\$30.00 family  
pass**



**Dance, drama, music, songs, performances, raffles,  
refreshments and much more!**

**Come along and enjoy the fun as we celebrate our  
first ever Diwali at  
Mount Roskill Grammar School.**

This project is to help fundraise for  
Mount Roskill Grammar Schools new water base hockey turf.  
More information contact Ella Kumar

Tickets available from MRGS school main office  
or

Ella Kumar: 09 629 0660, 021 0477642.

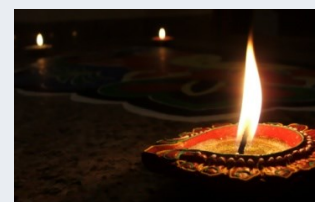





## NIWA AUCKLAND CITY SCIENCE AND TECHNOLOGY FAIR 2013

Congratulations to our young scientists and engineers for putting so much work into some great projects over the course of the whole year. Many thanks to the teachers, parents, and others for their motivation and help along the way. Finalists in the Mt Roskill Grammar competition included:

Daniel Bai, Heavy Light – Biology; Louise Barnes, Does Colour Affect Taste of Beverages – Biology ; Alice Wang, Crystal Clear – Material World ; Steffanie Kobayashi-Cox, Dance or Diploma – Biology ; Mihika Mehta, Cop Catch – Physics and Felix Yang, Confusing Collisions – Physics.

Finalists in the MRGS competition earned an entry into the NIWA Auckland City Science and Technology Fair. This year over 220 entries from 23 schools competed with a day of interviews and judging in the categories of technology, earth, space, biology, chemistry and physics. Highly commended entries and category winners can also be awarded special prizes from the Fair sponsors.

### MRGS Results for the NIWA Auckland Science and Technology Fair 2013

#### Highly Commended:

Shania Amolik, The Coca Cola Conundrum; Caleb Baptista, Shoe Station; Ellen Bingham, Is the Proof in the Pudding; Srishti Toora, Leaky Clues to Dam Design and Emily White, Put Your Best Paw Forward.

#### Category Winners and Special Prizes:

Vidit Bawa, Hydrodynamics in Action, 1<sup>st</sup> in Physics – Turbine design

Rohan Shetty, What Affects Sound Quality?, 2<sup>nd</sup> in Physics – Speaker enclosures

John Bayldon, In Tune?, 3<sup>rd</sup> in Physics – how temperature affects frequency

Juin Ma, Suspicious Solar Cells – Special prize Physics – effectiveness of solar cells;

Sarah Dun, Cheesy Crater – Special prize Earth and Beyond – Moon craters

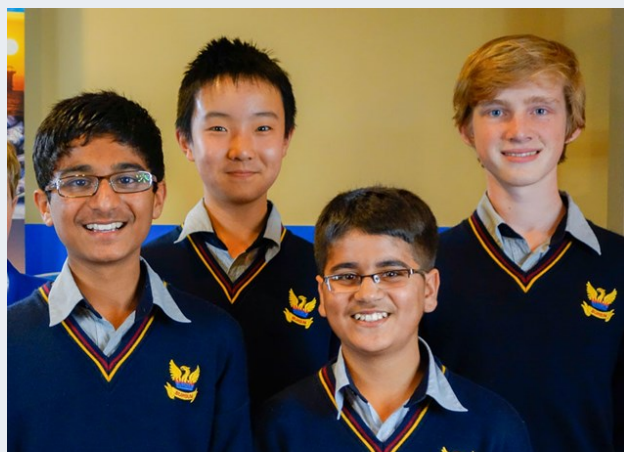

All four winners in the Physics section have also won the University of Auckland Physics Department - Scientist for a Day Prize.



Sarah Dun wins the Stardome Observatory Bronze Award

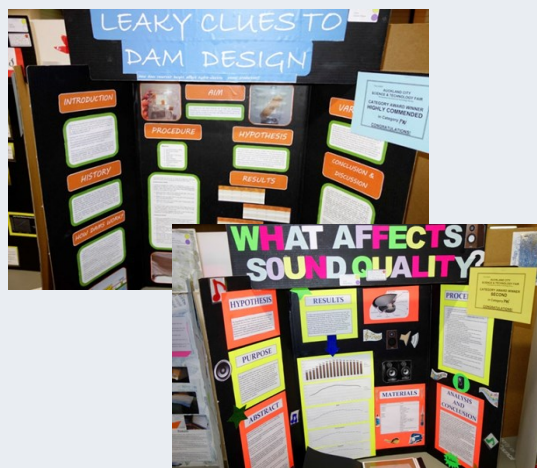
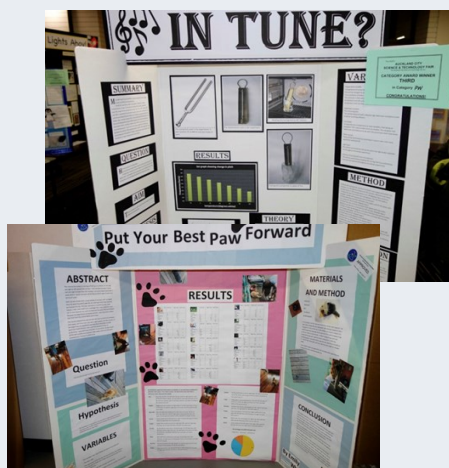



### YEAR 13 PRODUCTION—'WHEELER'S LUCK'

In the second to last week of term the Y13 Drama students staged their production of 'Wheeler's Luck'. They performed to large and appreciative audiences on two nights. The play, set in a small fictional Wai-kato town, follows the journey of a corporate man from Panmure who moves there in order to turn the town into a new Hamilton. The residents, unsure about the outsider's plans and led by the local postie Murray, become involved in disputes, wagers and some fascinating confrontations as the potential impact of the corporate man's plans become apparent. The conflict between the postie and the corporate man comes to a head in a marvellously depicted running of the town's annual horse race when the fate of the towns reserve land is decided—to be either a nature area or a casino centred economic development. The drama entertained everyone with hilarious dialogue, fantastic small-town fashion and impressive acting. The well-received show was completely run by students for their end of year internal assessment and its success is a tribute to their skill, hard work and the inspiring teaching in the Performing Arts department.

Mt Roskill Grammar School  
Year 13 Drama present

# Wheeler's Luck

Written by Nigel Collins, Toby Leach and Damon Andrews

Thursday 19th and  
Friday 20th September

7pm  
\$5 tickets from PFA  
Butler Hall  
Suitable for mature audiences

## Cast/Crew

Vaimaila Baker	Queenie / Nora
Louann Campos	Joe / Kevin
Saale Ilaua	Richard (Friday)
Wai Lun Law	Daryl / MC Reul
Theo Loretz	Richard (Thursday)
Josephine Marearai	Beryl / Trev / Molly
Talia-Rae Mavaega	Cilla
David Morris	Andy
Keerthi Nallur	Derek / Old Man Cox
Roshan Nama	Murray (Thursday)
'Alilia Palu	Perry
Laumanu Paseka	Phil, Alan, Mike
Samah Shazia	Murray (Friday)
Erin Steel	Trish
Ankita Tah	Beryl / Trev / Molly
Pewi Tuialii	Jonny / Neil / Horse
Esther Usumaki	Ron / Maureen
Grayson Yandall	Duncan
Angel Yu	Lydia / Dude / Horse
Sophie Galea	Stage Management
Diane Sevele	Costume
Sharon Stanley	Costume
Sam Chiwakul	Lighting
Venkat Prakash	Sound
Sarah Jadallah	Makeup
Ella Smith	Choreography





## SCHOOLS TOURNAMENT WEEK NEWS

In the week before Senior Exams four of our Premier teams went to tournament week. This event provides a highly competitive finish to the season for these teams and gives them the opportunity of playing against teams from around New Zealand.

**The Premier Netball team** played in Howick and won 4 out of 10 games. They finished in 21<sup>st</sup> position out of 32 teams, an improvement on last year.

**The 1<sup>st</sup> XI Boys Football team** went to Hamilton for their competition and won 3 out of 7 games. They finished in 14<sup>th</sup> position.

**The 1<sup>st</sup> XI Girls team** played in Papakura and won 5 out of 8 games. They won their playoff match on penalties to finish in 13<sup>th</sup> position.

**The Boys Basketball team** competed on the North Shore. This was the first time the team had entered this competition and they managed to beat teams graded above them and also beat teams they had lost to during the season. They won 4 games and lost 4 games, finishing in 12<sup>th</sup> position, the best result for all of the teams that went on tournament.



## SCHOOL CROSS COUNTRY

After some concerns about potential rain in the days before the weather finally smiled on the school recently and we had excellent conditions for the annual running of the Cross-Country event.

After morning lessons we had an early lunch and then the various year levels changed for this great community event. Students gathered on the hockey turf before being released in year groups to take on the local course through the environs of Roskill. The first group to go was that of the championship event runners who completed the route in fast times.



After this the different groups made their way in a positive afternoon of exercise and rivalry. Many ran the whole course others managed a mixture of running and jogging but they made it back to school in good spirits. Runners in each category gained points for their house and the final house placings were: 1st Yellow, 2nd Orange, 3rd Green, 4th Red and 5th Blue.

In the championship section Brian Dias was first in the Junior boys and

Karishma Kumar won the junior Girls. In the Intermediate section, Abishek Jeevan took first place amongst the boys and Victoria Mulrennan took first place in the girls. The Senior Boys championship was won by DeMaio Bury Vilela and Vandhana Tularam gained first place in the Senior Girls after a close finish with Cherie Walpole, Vandhana winning by 1 second.





## SCHOOL CHESS NEWS

Our school chess teams have had their most successful year ever. Five MRGS chess teams have battled throughout the year against other secondary schools around Auckland in the NZ Chess Federation competition to see who the Auckland Champions are. After playing over 140 games up to two hours long, our Senior and Junior teams both qualified for the Auckland Finals. Our Second Division senior team missed qualifying by just half a point. Our Senior team finalists of Kalyan Todha, Kashyap Choudhary, Nicholas Power, Vali Fa'aea placed 4<sup>th</sup> after 3 days of pitched battle. Also our Junior team of Joshua Simmons, Elvin Zhang, Max Wu, Shinay Singh and Cathy Fan defeated Auckland Grammar School's top Junior team – a portent for the future.



We also competed in the faster paced 30 minute games organised by ChessPower and we won our first tournament in West Auckland in April, which gave us a place in the National Finals. Top players who received medals were Kashyap Choudhary, Eric Chow, Nathan McDougall, Shinay Singh, Max Wu and Sehej Juenja, as well as the top girl in the tournament, Stella Xu. The MRGS team won the South Auckland regional ChessPower tournament, narrowly defeating Papatoetoe High and Rosehill College. Top players were Kashyap Choudhary, Daniel Morrin, Zi Yuan Tee, Nathan McDougall and Eric Chow.



Then on 11 September we attended the ChessPower National Finals. This was a tense battle through the first eight rounds which took us to 4<sup>th</sup> place. But a superb performance in the final round saw us see off Nelson College, Papatoetoe High School, St Andrew's College (Christchurch) and our old rivals Christchurch Boys' High School, to take second place behind our arch-rival Auckland International College. The names and reputations of these schools is a reflection of the high quality of the competition.

We have been third for the past two years – 2<sup>nd</sup> place is a great achievement, with top players on the day being Eric Chow, Elvin Zhang, Vali Fa'aea and Kashyap Choudhary. We missed our top player Kalyan Todha, who unfortunately had to sit a practical physics exam on that day. The fact we could still achieve such a significant result is a reflection of the strength and depth of skill in our chess team across all the school years. We expect greater results in the future.

We are continuing our school competition to determine our school Junior, Girls, and Senior Champions. Chess players meet every lunch-time in E1 for games and training this year and into 2014 – we cater for all levels of chess players from beginners to the experienced. Come along for fun, competition and the chance to represent your school at national level competitions.







## GATEWAY – “ANOTHER FANTASTIC YEAR”

2013 has been another fantastic year for the MRGS Gateway programme. This year we increased the number of placements available to 38 students and we expanded the range of workplace opportunities available. Placements were found in Fashion, Retail, Tourism, Hospitality, Engineering, Pharmaceutical, Commerce, Nursing, Medicine, Sports and Early Childcare. Students achieved NZQA credits and valuable qualifications in their chosen field.

As a result of the success of the programme and the willingness of our students, we are pleased to report that a number of students have been offered positions both full time and part-time.

If you are in Yr13 next year, application forms for 2014 will be available shortly. Keep an eye out on the daily notices.

**If you are a business and would like to offer a life changing work experience opportunity for a year 13 student in your company in 2014 or you have any questions regarding the programme, we would love to hear from you!! Please contact [gateway@mrgs.school.nz](mailto:gateway@mrgs.school.nz)**





# MRGS Fundraising Quiz Night

Friday 8<sup>th</sup> November 7.00 pm

In School Staffroom

**\$20/ticket (includes pizza supper)**

Adults only. Drinks and Raffle available for sale

**Experienced Quizmaster and a fun night to be had – teams of 5-6**

**Prizes for Quiz Night Winners & the Team with the Best Themed Outfits**

Support the School by coming along – we can put you in a team or you can book your own team a table.

**All money raised will go to the Water Based Hockey Turf & Sports Pavilion Development Fund**

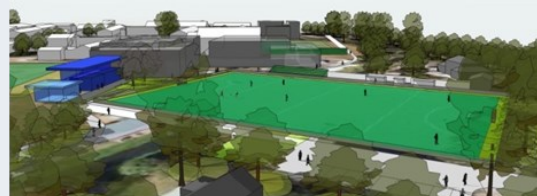

Tickets can be purchased from Accounts or paid for in advance and picked up on the night.

Direct Credit to MRGS Board of Trustees 12-3033-0358045-02 include your name & the Ref "Quiz".

Confirm your booking by contacting Alan McNair [aalanmcnair@aol.com](mailto:aalanmcnair@aol.com)

## MANGERE/MANGERE BRIDGE STUDENTS: BUS SERVICE

**Kiwi Coach Charters** currently offer a bus service from Mangere/Mangere Bridge to other schools in our area.

If enough students are interested from MRGS and Mount Roskill Intermediate they will arrange a bus to come to the Mount Roskill campus and are open to tailoring the route to suit our students.

The current cost is \$30/week (\$1260/year) or you can pay termly. The cost may increase slightly in 2014.

They have allowed for on average one "non-ride" per week due to sickness, sport or school activities.

If you are interested please contact Kiwi Coach Charters directly [info@kiwicoachcharters.com](mailto:info@kiwicoachcharters.com) or phone them on 09 636 5232.

## SECOND HAND UNIFORM:

As we come towards the end of the year there is an opportunity to sell your uniform using a community based system.

There are small advertising cards available in the Deans' Centre.

Write what you have to sell and your contact number on the card.

The card will be placed in the Deans' Centre window by a designated prefect.

The cards will be removed after three weeks.

This is a community run initiative and the school is not responsible for any handling of money.



## PHOTOGRAPH ORDERING

Photolife now have the MRGS photos for teams, cultural groups, prefects, mediators up on line for students and their families to view and then order. Ordering on-line provides families with a more direct link to the photographs available.

Each student who is a member of any of the above listed groups has been issued with an information slip in form time which includes a 'Shoot Key' code. The instructions for accessing the photographs and ordering them by using the code are on the slip. The shoot key code provides security so that the photos cannot be accessed by everyone. It is therefore important that this code is not shared. There is a free delivery period of three weeks available and this date is shown on-line when the photos are viewed.

For families who are not able to order on line please contact Mardia Te Whiu by phoning 09 621 0050 ext 852. Julie Small, Deputy Principal

## SAFE PARKING AROUND THE SCHOOL CAMPUS

### Park safely and keep our kids safe

Our school is participating in Auckland Transport's 'Safety at the School Gate' programme. Drivers who stop in the wrong place to drop off passengers put the safety of children at risk.

Parking officers will be on patrol outside the school this term and will be issuing tickets to drivers who park illegally.

**The agreed approach is 'zero tolerance'** – There will be no warnings issued, you will receive a ticket if you are double parked, parked on yellow lines, or over someone's driveway – or for any other vehicle safety offence.

**Please park legally to keep our children safe and to avoid being ticketed.**



## Park safely outside schools

Before and after school is a busy time for everyone. Parking rules help protect our children and keep them safe. Drivers who park illegally put our kids at risk.

This term parking officers will be on patrol outside your school to issue tickets to those who are illegally parked.

### Fines for illegal parking include:

- |  |      |
|--|------|
| • Parked on the footpath or grass verge/ berm  | \$40 |
| • Parked across or within 1m of a vehicle entrance   | \$40 |
| • Parked within 6m either side of an unmarked bus stop                                     | \$40 |
| • Parked within a marked bus stop  | \$60 |
| • Parked within 0.5m of a fire hydrant with no one in the car legally capable of moving it | \$60 |
| • Parked within a designated bus lane, transit or cycle lane                               | \$60 |
| • Parked on a clearway   | \$60 |
| • Double parked  | \$60 |
| • Inconsiderate parking to other road users, including pedestrians                         | \$60 |
| • Parked on or within 6m of an intersection  | \$60 |
| • Parked on a pedestrian crossing  | \$60 |
| • Parked on a broken yellow line   | \$60 |

*These parking offences are detailed in the New Zealand Road Code.*

Thank you for your cooperation.







## Visual Arts Department and Pah Homestead Community Day

Students and staff from the Visual Arts Dept of the school will be exhibiting work and participating in the Pah Homestead Community Day. It promises to be a great celebration of Puketapapa's/Mt Roskill's cultural, creative and community heritage. The exciting community day includes art displays, cultural performances, music, creative demonstrations, cultural workshops, storytelling, face painting, art quizzes, Ki-O-Rahi, a chocolate spray gun demonstration and much more.

Pah Cafe will be open : \$1 per a hot beverage purchased goes towards a Mount Roskill Grammar School student art prize. We hope that members of the school community will support the day—details at:

<http://www.aucklandcouncil.govt.nz/EN/newsevents/culture/events/Events/Pages/pahcommunityday.aspx>



## UNITED NATIONS INTERNATIONAL DAY OF PEACE



On Saturday 21 September, four of our Mediators represented MRGS at the United Nations International Day of Peace in Auckland highlighting the importance of “Education for Peace”.

A range of Peace experts attended, including the Peace Foundation, Auckland City Councillors, Church Reverends and Peace activists. Our Mediators, Diana Qiu and Ayesha Nadat spoke passionately and eloquently about what peace means for them and our youth. Their heartfelt words touched the audience giving them hope for the future.

Saale and Fotu Ilaua sang brilliantly our winning Peace song from last year “A Brighter Future”, written by Saale.

The MC of the day, Gerald Trass ( a past student of MRGS) said after our school’s performance: “ The MRGS motto is SURSUM ‘to the heights’ and the MRGS performances have certainly done this today”.





## WIDER EDUCATION YEAR 9 AND 10 - WEDNESDAY 4<sup>TH</sup> – FRIDAY 6<sup>TH</sup> DECEMBER

Wider Education is a tradition at MRGS which is an opportunity for students to be involved in valuable learning activities that are based outside of the classroom. Students will be challenged by new experiences, make new friends, learn new skills while having fun completing a wide range of activities.

Year 9 trips comprise of day trips that are based around the Auckland area, while Year 10's are expected to attend a camp or a three day trip programme.

This year the trips and camps cover a wide range of activities and venues, and although there is a cost associated with each activity we have endeavoured to keep these to a minimum. A deposit of \$25 for day trips and \$50 for residential trips is needed to secure placement, which is now overdue. Final payments are to be made by 30<sup>th</sup> October.

For more information please refer to the hand out given to students by Form Teachers earlier this term, or the school website.

Ms. L Leman

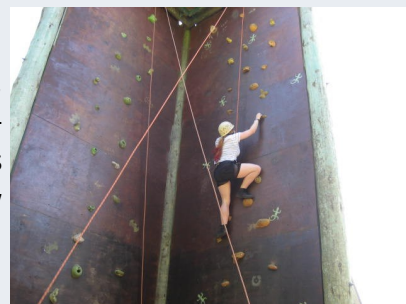

## FOOD AND HOSPITALITY DEPARTMENT



During the Term Three exam cycle our senior Food and Hospitality students hosted functions/cafes:

11 Food and Hospitality put on a Hot Finger Food and Mocktails function and students each invited a teacher. They made a range of hot finger foods and mocktails from the units they had been working on this term.

12FHS ran two High Teas Cafes. They developed and made their own selection of cakes and hot and cold sandwiches. Teachers enjoyed choosing their own selection of treats and being served a variety of teas such as rosehip, liquorice, hibiscus and Japanese genmaicha.

13 Food and Hospitality have been working on integrated units on Food Safety, Knife use, Salads and Grilling. They ran a Salad Bar which was enjoyed by a number of teachers.

13 Catering and Hospitality worked under pressure to produce a variety of baked products for presentation in a lead up to their Level 3 summative practical assessment at MIT.







## MT ROSKILL GRAMMAR SCHOOL

### ADULT COMMUNITY EDUCATION - TERM 4 2013

Frost Road, Mt Roskill, Auckland 1041

[www.mrgs.school.nz](http://www.mrgs.school.nz) (click on Community Education)

Phone (09) 621 0051

Email: [jennifer.carson@mrgs.school.nz](mailto:jennifer.carson@mrgs.school.nz)

Fax: (09) 620 9467

Office Hours: 9am-3pm Monday to Friday. Extra enrolling night: Wednesday 16 October 6-8pm.

MONDAY starts 21 October 7-9pm unless stated			TUESDAY starts 22 October 7-9pm unless stated		
Alexander Technique <b>*6.45-8.15pm</b>	6 wks	\$85	Digital Photography & Photoshop- An Introduction		
Ballroom Dancing for Beginners <b>*7-8pm</b>	6 wks	\$55	<b>*DSLR Cameras</b>	7 wks	\$98
Basic Car Maintenance	6 wks	\$90	<b>*Compact Cameras – starts 5 Nov</b>	5 wks	\$75
Cake Decorating Christmas Cakes	7 wks	\$95+	Dressmaking - Beginners	8 wks	\$85+
Computer Maintenance & Repairs – Intro	4 wks	\$70	Floristry – Beg to Int	7 wks	\$89+
Computer Maintenance & Repairs -	3 wks	\$65	Home Renovations <b>*6.30-8.30pm</b>	3 wks	\$56
Advanced <b>*Starts 25 Nov 6.30-9pm</b>			Indoor Soccer – Men <b>*7.35-9pm</b>	7 wks	\$67
Furniture Making & Design <b>*6-9pm</b>	7 wks	\$139+	Indoor Soccer – Women <b>*6-7.30pm</b>	7 wks	\$67
Painting with Oils	7 wks	\$95+	Moroccan Cooking	4 wks	\$70+
			<b>*Fee includes first night's ingredients</b>		
Patternmaking – Advanced	7 wks	\$110	Pilates <b>*6.30-7.30pm</b>	7 wks	\$65
Planning & Budgeting for the Summer	3 wks	\$40	Outsourcing Options for Small Business	1 wk	\$20
			<b>*26 November, 7-8.30pm</b>		
Holiday Season <b>* Starts 4 November</b>			Promotional Video for Small Business	1 wk	\$20
			<b>*19 November, 7-8.30pm</b>		
Sign Language – Beginners 1B	7 wks	\$50	Sign Language – Beginners 1A	7 wks	\$50
Thai Cooking <b>*Ingredients extra</b>	4 wks	\$58+	Skype for Small Business	1 wk	\$20
			<b>*3 December, 7-8.30pm</b>		
Toastmasters Speechcraft	5 wks	\$195	Welding for Beginners <b>*6.30-8.30pm</b>	6 wks	\$200+
Yoga <b>*6.45-8.15pm. Bring mat</b>	7 wks	\$67	Woodwork & Furniture Restoration	8 wks	\$95+
Yoga- Prenatal <b>*6.45-8.15pm Bring mat</b>	7 wks	\$67	Cloud Storage for Small Business	1 wk	\$20
			<b>*12 November, 7-8.30pm</b>		
TUESDAY starts 22 October 7-9pm unless stated			WEDNESDAY starts 23 October 7-9pm unless stated		
Badminton <b>*6.30-8.30pm</b>	7 wks	\$85	Advanced Car Maintenance	6 wks	\$115
Bollywood Dancing <b>*7.30-8.30pm</b>	7 wks	\$70	Aerobics Pump <b>*7-8pm</b>	7 wks	\$49
Bootcamp <b>*6.30-7.30pm</b>	7 wks	\$49	Cake Decorating: Sugar Flowers	7 wks	\$95+
Building a Website with Weebly <b>*7-8.30pm</b>	2 wks	\$40	Dressmaking: Intermediate	8 wks	\$85+





## MT ROSKILL GRAMMAR SCHOOL

### ADULT COMMUNITY EDUCATION - TERM 4 2013

### ( Programme Continued )

WEDNESDAY starts 23 October 7-9pm unless stated			ENGLISH AS A SECOND LANGUAGE CLASSES		
Festive (Xmas) Baking Fun	4 wks	\$70+	Non-residents pay 30% extra on advertised fee		
<b>*Fee includes first night's ingredients</b>			<b>DAYTIME CLASSES</b>		
French for Beginners & Travellers	7 wks	\$98	<b>Conversational English and Grammar – starts 14 Oct</b>		
Indoor Soccer <b>*16 Oct, 7.30-9pm</b>	9 wks	\$86	Mon, Wed, Fri 9am-12noon	9 wks	\$360
Italian Cooking <b>Starts 20 November*Fee includes first night's ingredients</b>	4 wks	\$70	Level 1 Beginners/ Elementary		
Spanish for Beginners & Travellers	7 wks	\$98	Level 2 Pre-Intermediate		
Tennis – Beg to Int <b>*6-8pm</b>	6 wks	\$75	Level 3 Intermediate/ High Intermediate		
Woodwork – Beg to Intermediate	8 wks	\$95+	<b>Academic &amp; General IELTS Prep – starts 15 Oct</b>		
Yoga <b>*Starts 31 July, 6.45-8.15pm</b>	9 wks	\$86	Tues & Thurs 9.15-11.15am	9 wks	\$240
<b>GUITAR CLASSES - Start Thurs 24 &amp; Fri 29 Oct</b>			<b>EVENING CLASSES</b>		
Beginners - Thursday 7-8pm	7 wks	\$75	<b>Mon &amp; Wed classes - start 21 October *2 nights per week, 6.40-9pm, 7 wks, \$99</b>		
Intermediate – Thursday 6-7pm	7 wks	\$75	Beginner/ Elementary		
Intermediate - Thursday 8-9pm	7 wks	\$75	Pre-Intermediate		
Intermediate - Friday 6-7pm	7 wks	\$75	Intermediate		
Advanced - Friday 7-9pm	7 wks	\$125	High Intermediate		
<b>SATURDAY CLASSES</b>			<b>Tuesday classes – start 22 October *1 night per week, 6.40-9pm, \$50</b>		
<b>Sushi:</b> 16 November, 9.30am-12.30pm, \$35 + \$20 ingredients	1 wk		Advanced Grammar & Vocabulary		
<b>MYOB:</b> 9 & 16 Nov, 9am-4.30pm,	2 wks,	\$135	Speaking & Pronunciation		
Please note: A "+" after a price indicates that there may be further material costs involved			<b>Academic &amp; General IELTS Prep – starts 6 August*7 wks \$170</b>		
You must be a minumum of 16 yrs to join these classes			Tues and Wed (2 nights), 6.40-9pm, ,		
For full details of classes, see our website:			<b>IELTS Preparation Stage 2 – Mondays 6.40-9pm start 2 1 Oct + Saturdays 9 &amp; 16 Nov 9am-4.30pm, \$170</b>		
<b>HOW TO ENROL:</b>					
- At the office: Eftpos is available					
- Call on 621 0051 with your credit card					
- Email <a href="mailto:jennifer.carson@mrgs.school.nz">jennifer.carson@mrgs.school.nz</a>					
- Download a form from our website: <a href="http://www.mrgs.school.nz">www.mrgs.school.nz</a> , click on "Community Education"					



### SPONSORSHIP FOR ROSKILL SPORTS TEAM

The MRGS Girls 1st XI Football team is proudly sponsored by the following businesses :-

<b>Mark Hewett Director</b> mobile phone : 027 627 2127 email: hewett@xtra.co.nz	<b>CERTIFIED INSTALLATIONS LIMITED</b> office phone : 09 627 2127

**certified INSTALLATIONS**

## P.J. AUTOMOTIVE

FOR ALL YOUR MOTORING NEEDS

**Philip Whiteford**  
OWNER/OPERATOR

87 Carr Road, Mt Roskill, Auckland 1041  
 Ph: 0-9-629 2770, Fax: 0-9-629 2477, Mob: 021-566 332  
 Email: pjautomotive@paradise.net.nz  
 PJW Services Ltd T/A P.J. Automotive

• **W.O.F.**

- Brakes • Shocks
- Mufflers • CV Joints
- All Mechanical Repairs
- Tyres - Full range & Service
- Auto Electrical repairs • Batteries
- Car Alarms • Stereos • Car Phones
- Towbars • Bike Racks • Accessories

## PROFESSIONAL TREE CARE

INCLUDING REMOVAL OF DEAD AND WIND DAMAGED WOOD,  
 THINNING FOR LIGHT AND VIEW, COMPLETE REMOVAL,  
 SPECIMEN TREE PLANTING.

### HEARTWOOD TREES LTD. ARBORISTS

MARK CORBETT, 29 MILLIKEN AVE., MT ROSKILL PHONE: 620-8494

## PAK'nSAVE

**Mt Albert**

**Steve Cadwallader**

14 Parfitt St,  
 Mt Roskill,  
 Auckland 1041

027 6437400  
 627 3973 a/h

caddysdrainage@hotmail.com



### ASB BBQ DONATION

At the end of term the school gratefully accepted the generous donation of a BBQ from the ASB bank. This will be used regularly as part of the school's fundraising sausage sizzles.



### SCHOOL SPONSORSHIP

Mount Roskill Grammar School would like to thank the following businesses for their ongoing generous financial sponsorship and support ;

Konica Minolta, Libelle and Barfoot & Thompson – Mt Roskill



*Document Solutions Tailored to Fit Your Business*

Proudly Supported by

**Barfoot & Thompson**  
LIVESTOCK BROKERS

**Mt Roskill, 09 621 0912**







### SPONSOR'S SPECIAL OFFER

Cameron Pools one of the proud sponsors of our 1stXI girls Football Team are offering this special for Mount Roskill Grammar Students.



**CAMERON POOL**

# YOUTH MEMBERSHIP

for school students 16yrs+  
**MON-SUN 6AM-6PM**

Mt Roskill Grammar & Lynfield College students \$5 entry 3pm-5pm Mon-Fri

**ONLY \$12.50 PER WEEK**

**GET ACCESS TO OUR GREAT**

- FITNESS CENTRE
- GROUP FITNESS CLASSES
- SWIMMING POOL
- SPA, SAUNA & STEAM

**SPECIALIZED YOUTH TRAINER DAVID AVAILABLE**

Find out more: Cameron Pool  
53 Auckland St, Mt Roskill  
Ph: 09 624 6008  
www.cameronpool.co.nz

**Auckland Council**

### MOUNT ROSKILL GRAMMAR SCHOOL BOYS 1ST XI FOOTBALL

In August 2013 a raffle was held to raise funds for the team to attend Tournament Week in Hamilton.

Approximately \$1,500 was raised.

Congratulations to all the winners.

#### THANK YOU FOR THE GENEROUS SUPPORT OF:

Countdown Three Kings

Countdown Mt Roskill

Aussie Butcher, Frost Rd, Mt Roskill

New World Mt Roskill

Tulip Cafe, Carr Rd

St Pierre's Sushi, Mt Roskill

Send A Chocolate Cake

Paper Plus Royal Oak

Baker's Delight Royal Oak

Nestle New Zealand Ltd

Thai Chefs, Parnell

Penelope Parnell Cafe

Nosh Greenlane

Henderson Cars Ltd, Takanini and Manurewa

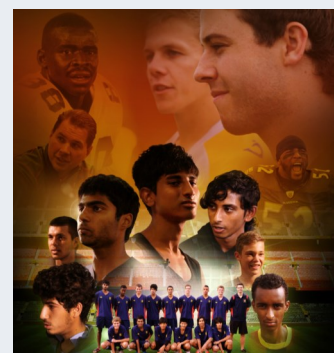

*Thank you also to the parents and the team for their time and effort spent on this fund raiser.*